

**From:** [REDACTED]  
**Sent:** 25 July 2019 15:57  
**To:** [REDACTED]  
**Subject:** RE: Rocklands  
**Attachments:** HS\_FA\_19\_00172.docx

Hi [REDACTED]

Further to our discussion, please find attached the screenshots as requested.

Please let me know if I have missed anything.

Also can you confirm which is any of these you will need for any committee powerpoint presentation.

Kind Regards

[REDACTED]  
Development Management  
Hastings Borough Council  
[REDACTED]

---

**From:** [REDACTED]  
**Sent:** 19 July 2019 14:51  
**To:** [REDACTED]  
**Subject:** Rocklands

[REDACTED]  
Please would it be possible to provide me with an image for committee/assessment of the application that shows:

- The proposed patio area as set out for application HS/FA/19/00172
- The tree/planting locations as approved in HS/CD/16/00655 – details are on page 18 of the approved Planting Schedule & Planting, Maintenance and Establishment Specification (July 2017)
- The proposed tree works as set out in current application HS/TP/18/00769 – indicative locations are set out on page 8 of the submitted Arboricultural Report.

The purpose of this exercise is to form a basis to determine whether the proposed patio area will encroach onto any tree works.

Your help would be appreciated

[REDACTED]  
Development Management  
Hastings Borough Council  
[REDACTED]

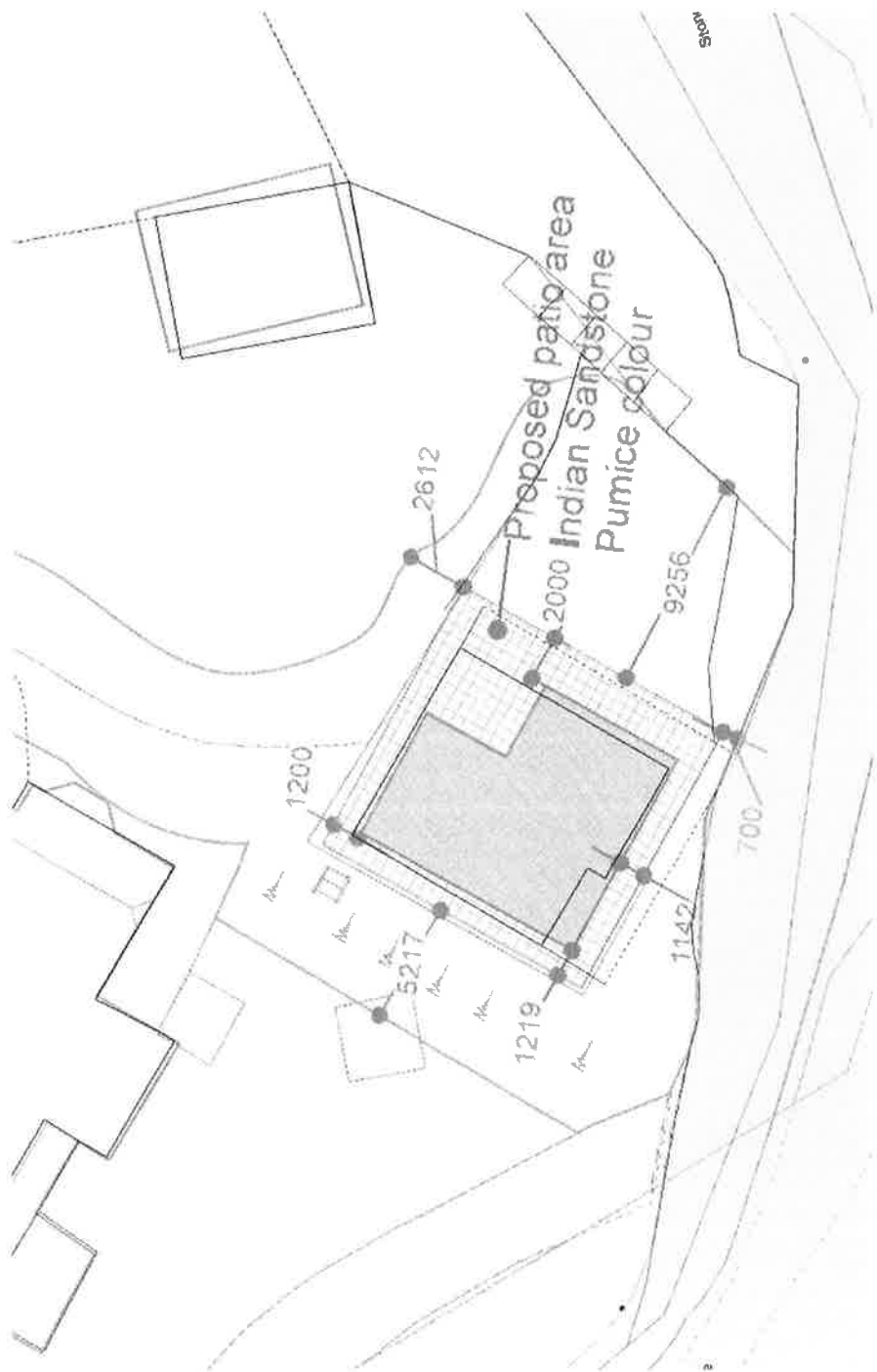

19/00172 - Block Plan showing location of TPO

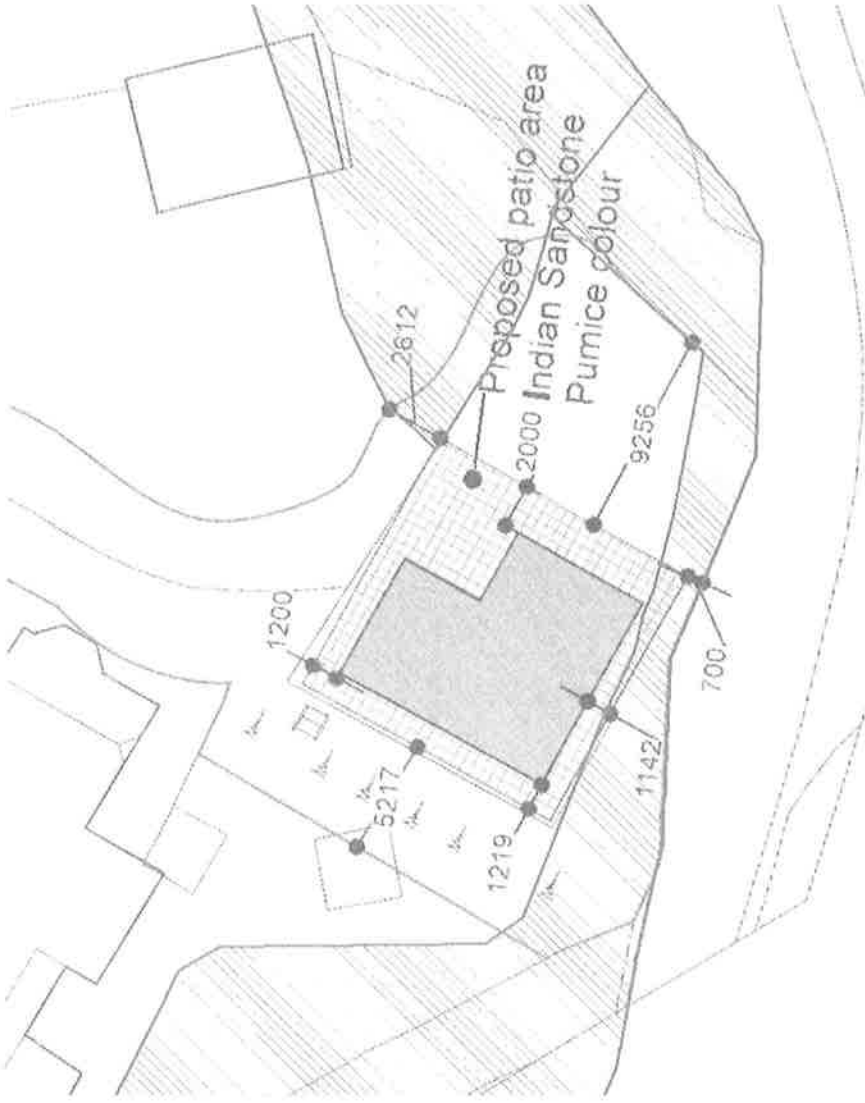

Tree/Planting Locations as approved in HS/CD/16/00655

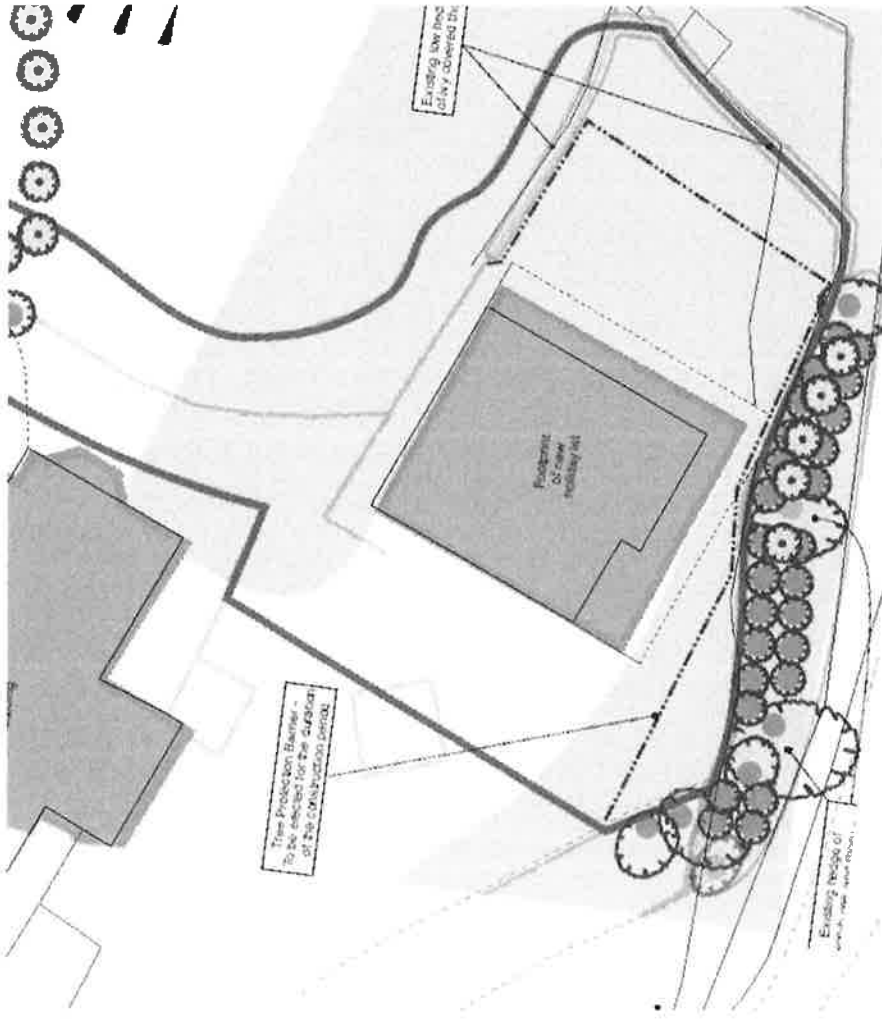

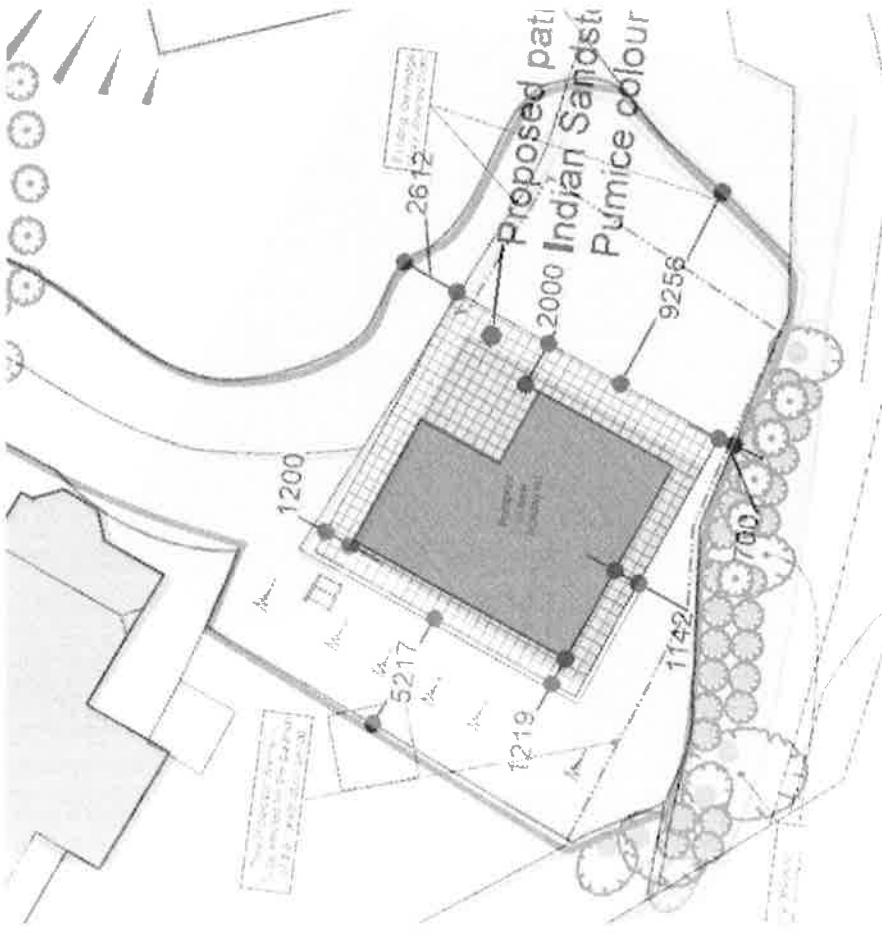

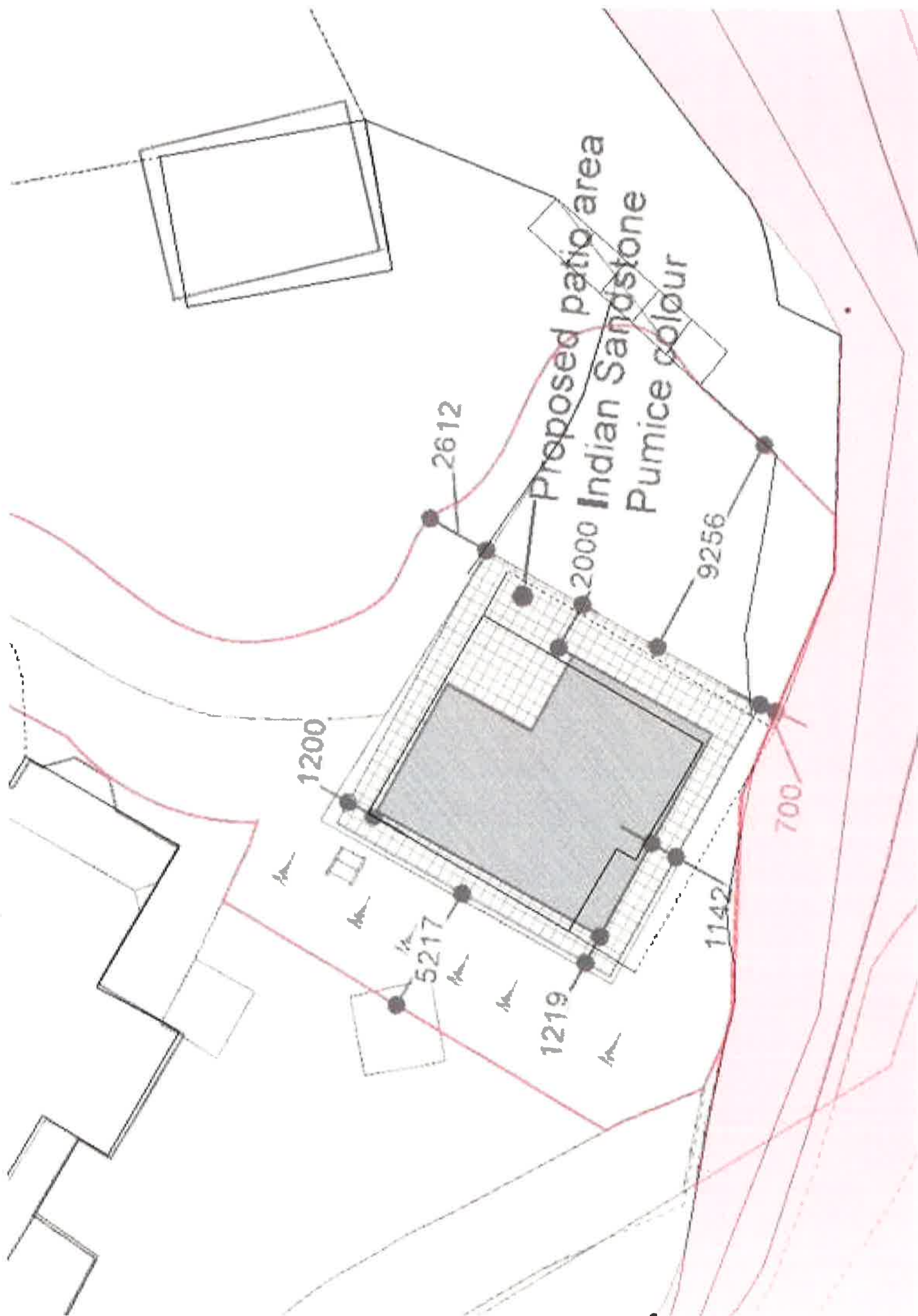

Proposed patio area  
2000 Indian Sandstone  
Pumice colour

2612

1200

5217

1219

1142

9256

700