

STRATEGIC HOUSING LAND AVAILABILITY ASSESSMENT SITES

1:2500

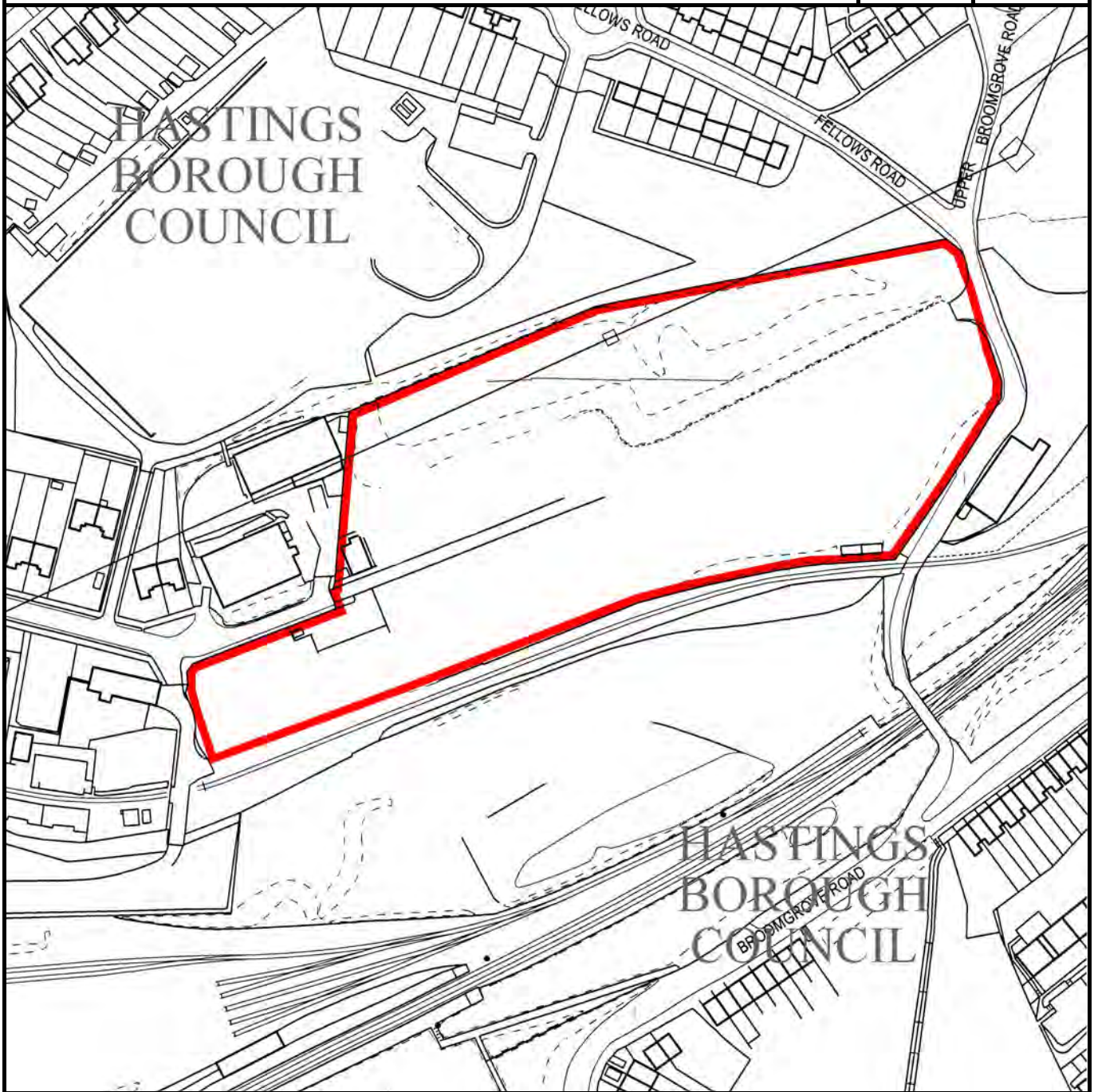

REPRODUCED FROM THE ORDNANCE SURVEY MAPPING WITH THE PERMISSION OF THE CONTROLLER OF HER MAJESTY'S STATIONERY OFFICE. © CROWN COPYRIGHT RESERVED. UNAUTHORISED REPRODUCTION INFRINGES CROWN COPYRIGHT AND MAY LEAD TO CIVIL PROSECUTION OR CIVIL PROCEEDINGS. HASTINGS BOROUGH COUNCIL LICENCE No 100021328

A18

BROOMGROVE REDEVELOPMENT AREA, FORMER POWER STATION



Hastings Borough Council,
Planning Services
Aquila House,
Breeds Place,
HASTINGS,
East Sussex.
TN34 3UY

**SITE
CURRENTLY
CONSIDERED
DEVELOPABLE**

January 2010